

**FULTON  
LABS**

AT 1375 WEST  
FULTON MARKET

**Available  
Immediately**







**FULTON  
LABS**

AT 1375 WEST  
FULTON MARKET

**Turnkey delivery  
model to minimize  
your risk and  
allow your team  
to stay focused on  
your science.**

**301,260 RSF**

14 Floors

**First Generation  
Lab Space**

Custom Designed

**Overhead  
Service Carriers**

**Robust Mechanical  
Systems**

**4'-6' Fume Hoods  
& Snorkels**

**Multiple  
Power Voltages**

Including 480V

**Backup Power  
Available**

**Column-Free  
Lab Spaces**

**Vivarium Access**

**Access-Controlled  
Building**

24-hour Security Presence



# STACKING PLAN

Mid-rise stack lab  
mechanical shaft and  
exhaust →

High stack lab  
mechanical shift  
and exhaust



**Level 14**  
Amenity Floor

**Levels 9-13**  
Lab Floors, 25,916 RSF floorplates

**Levels 4-8**  
Lab Floors, 35,004 RSF floorplates

**Levels 2-3**  
Parking

**Level 1**  
Lab and chem storage



# TYPICAL LOWER FLOOR SINGLE-TENANT FLOOR PLAN

35,004 RSF







- Amenity
- Balcony
- Laboratory
- Laboratory Support
- Office
- Office Support
- Core





# TYPICAL LOWER FLOOR MULTI-TENANT FLOOR PLAN

**SOUTH TENANT 18,932 RSF**

-  Amenity
-  Balcony
-  Laboratory
-  Laboratory Support
-  Office
-  Office Support
-  Core





# TYPICAL LOWER FLOOR MULTI-TENANT

# FLOOR PLAN

NORTH TENANT 16,072 RSF

- Amenity
- Balcony
- Laboratory
- Laboratory Support
- Office
- Office Support
- Core

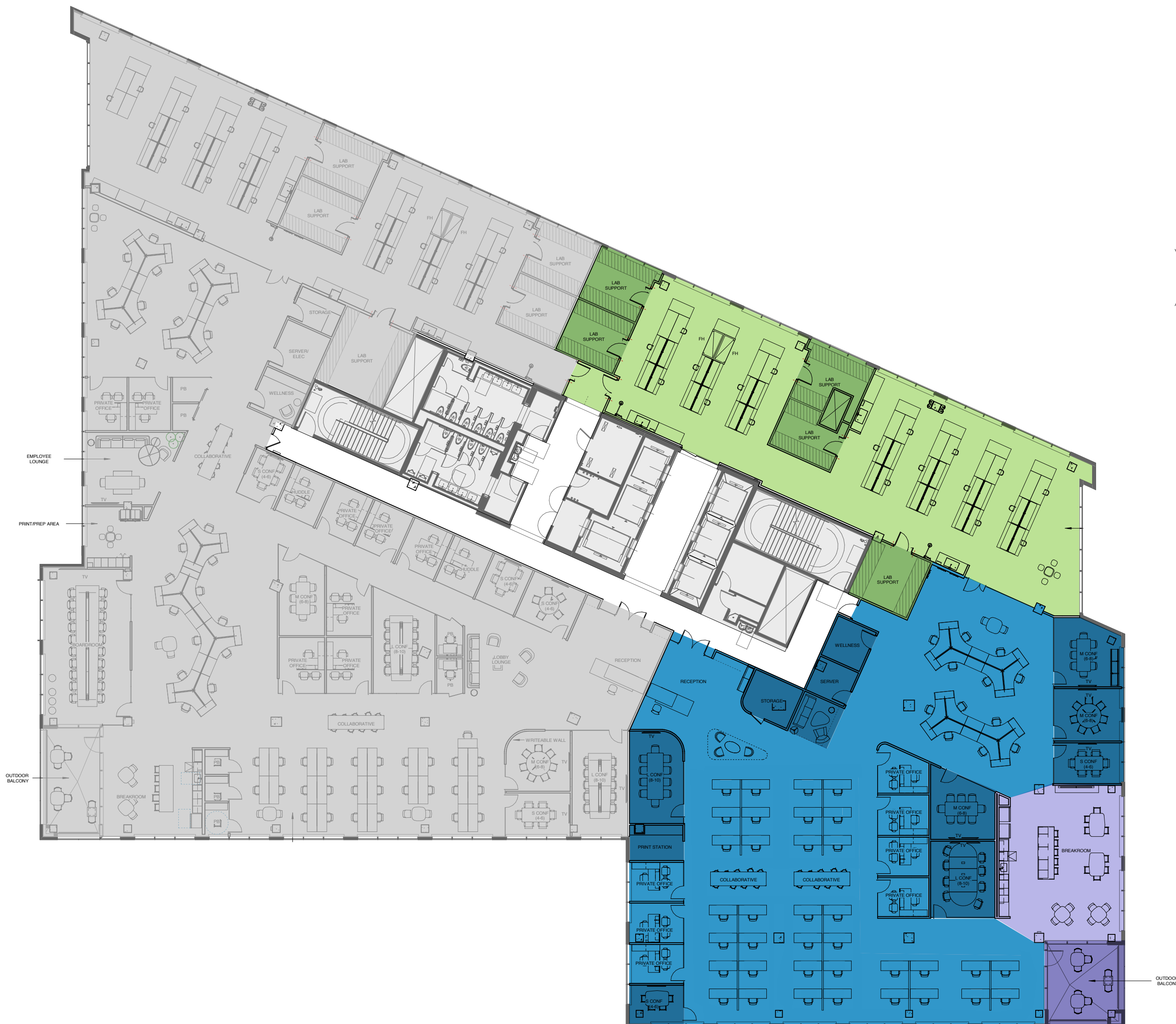



# TYPICAL UPPER FLOOR SINGLE-TENANT FLOOR PLAN

25,916 RSF

- Amenity
- Balcony
- Laboratory
- Laboratory Support
- Office
- Office Support
- Core

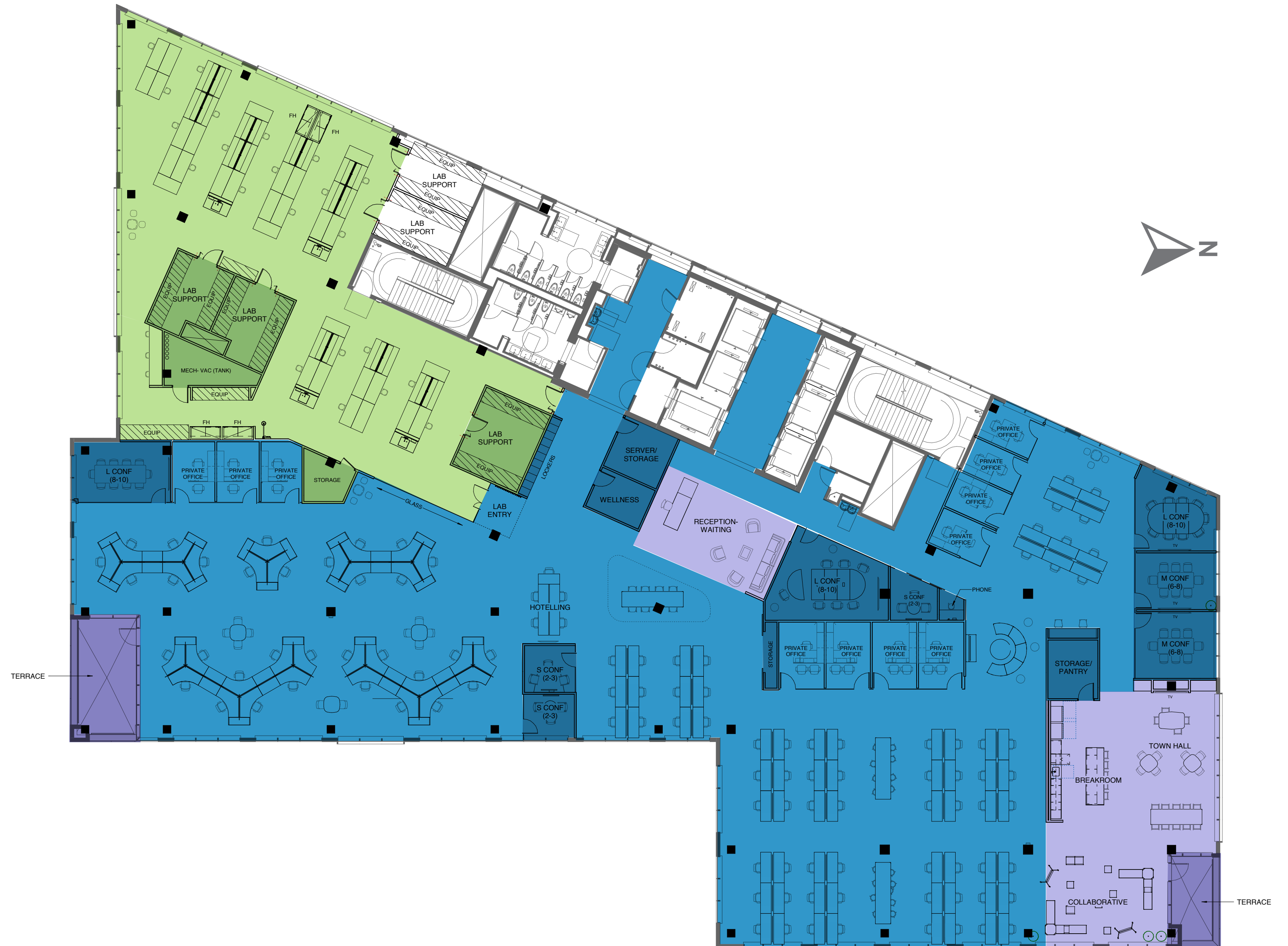



# 9TH FLOOR LAB FLOOR PLAN

11,562 RSF

-  Amenity
-  Balcony
-  Laboratory
-  Laboratory Support
-  Office
-  Office Support
-  Core

